



Benham & Reeves

Greenleaf Walk, Southall, UB1

£426 per week, £1,846 per month + fees

 2 Bedrooms  2 Bathrooms 
Furnished/UnFurnished

This stunning two bedroom apartment is situated in the Green Quarter, a new property development in West London. The apartment is located in Arber House with views overlooking landscaped gardens and surrounding parkland.

Please [click here](#) for full detail

Property features

Brand new | Residents gym | Concierge | Balcony | Wood floors | EPC-B | Cinema room | Full Height Windows | Nearby Southall Station

For more information about this property,
please call our Property Management branch on

020 7319 9740

Redress & Client Money Protection :

Benham and Reeves are members of The Property Ombudsman redress scheme and have Client Money protection with ARLA Propertymark. You can find more information on our website at <https://www.benhams.com/membership/>



Benham&Reeves

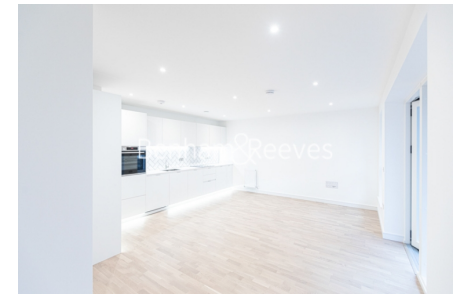

Greenleaf Walk, Southall, UB1

£426 per week, £1,846 per month + fees

www.benhams.com

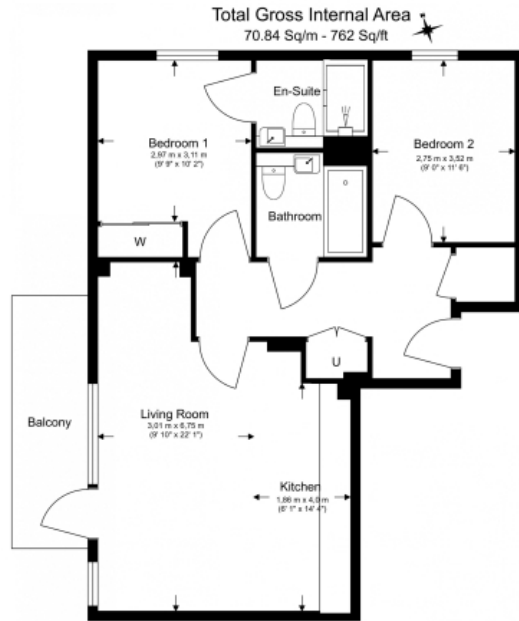

Floor Plan measurements are approximate and are for illustrative purposes only. While we do not doubt the floor plans accuracy, we make no guarantee, warranty or representation as to the accuracy and completeness of the floor plan.

Score	Energy rating	Current	Potential
92+	A		
81-91	B	84 B	84 B
69-80	C		
55-68	D		
39-54	E		
21-38	F		
1-20	G		

London branches open six days a week Mon - Sat

Canary Wharf | City | Colindale | Dartmouth Park | Ealing | Fulham
Hammersmith | Hampstead | Highgate | Hyde Park | Kensington | Kew
Knightsbridge | Nine Elms | Shoreditch | Southall | Surrey Quays
Wapping | Wembley | White City | Woolwich

International offices

China | Hong Kong SAR | India | Indonesia | Qatar | Malaysia | Middle East |
Singapore | South Africa | Thailand | Turkey



Benham & Reeves