



Benham & Reeves

**Greenleaf Walk, Southall, UB1**

£381 per week, £1,651 per month + fees

🛏 1 Bedroom    🚿 1 Bathroom    🛋 Furnished

This Stunning apartment is situated in an outstanding Berkeley development on the Western fringe of London featuring great views of the surrounding landscaped gardens. Perfectly located for Southall amenities and Southall Station (Elizabeth line) is within walking distance.

Please [click here](#) for full detail

## Property features

**1 Bedroom | Concierge | Balcony | Gym | Cinema room | EPC-B | Wood floors | Residents lounge | Southall Station**

For more information about this property,  
please call our Southall branch on

**020 8051 0800**

Redress & Client Money Protection :

Benham and Reeves are members of The Property Ombudsman redress scheme and have Client Money protection with ARLA Propertymark. You can find more information on our website at <https://www.benhamandreeves.com/membership/>



Benham & Reeves

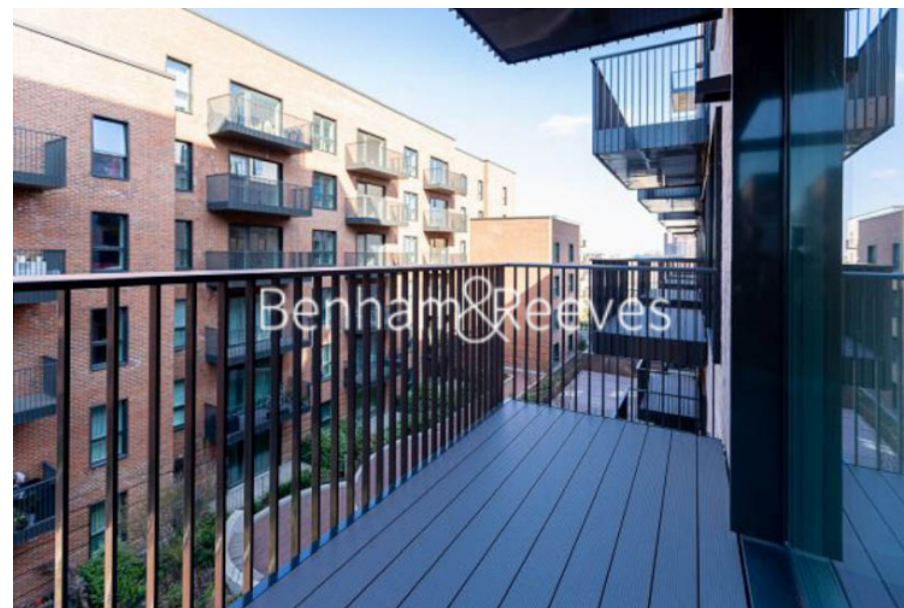

# Greenleaf Walk, Southall, UB1

£381 per week, £1,651 per month + fees

[www.benhams.com](http://www.benhams.com)

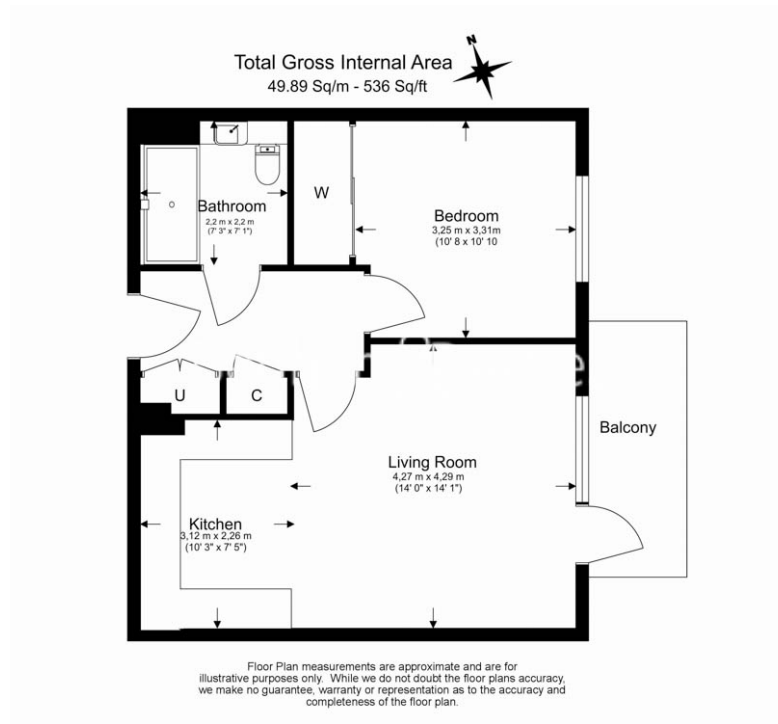

Score	Energy rating	Current	Potential
92+	A		
81-91	B	84   B	84   B
69-80	C		
55-68	D		
39-54	E		
21-38	F		
1-20	G		

## London branches open six days a week Mon - Sat

Canary Wharf | City | Colindale | Dartmouth Park | Ealing | Fulham  
Hammersmith | Hampstead | Highgate | Hyde Park | Kensington | Kew  
Knightsbridge | Nine Elms | Shoreditch | Southall | Surrey Quays  
Wapping | Wembley | White City | Woolwich

## International offices

China | Hong Kong SAR | India | Israel | Malaysia | Middle East | Pakistan  
Qatar | Singapore | South Africa | Thailand | Turkey



Benham & Reeves