



Benham & Reeves

Greenleaf Walk, Southall, UB1

£381 per week, £1,651 per month + fees

🛏️ 1 Bedroom 🚿 1 Bathroom 🚗 Furnished

A contemporary open plan design apartment situated within an outstanding Berkeley development on the in Western fringe of London featuring great views of the surrounding landscaped gardens. A brief walk from Southall Station (Zone 4).

Please [click here](#) for full detail

Property features

One bedroom | Concierge | Gym | Cinema room | Residents lounge | EPC-B | Balcony | Wood floors | Furnished | Nearby Southall Station (Zone 4)

For more information about this property, please call our Southall branch on

020 8051 0800

Redress & Client Money Protection :

Benham and Reeves are members of The Property Ombudsman redress scheme and have Client Money protection with ARLA Propertymark. You can find more information on our website at <https://www.benhams.com/membership/>



Benham&Reeves

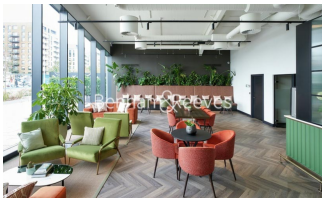

Greenleaf Walk, Southall, UB1

£381 per week, £1,651 per month + fees

www.benhams.com



Score	Energy rating	Current	Potential
92+	A		
81-91	B	81 B	81 B
69-80	C		
55-68	D		
39-54	E		
21-38	F		
1-20	G		

London branches open six days a week Mon - Sat

Canary Wharf | City | Colindale | Dartmouth Park | Ealing | Fulham
Hammersmith | Hampstead | Highgate | Hyde Park | Kensington | Kew
Knightsbridge | Nine Elms | Shoreditch | Southall | Surrey Quays
Wapping | Wembley | White City | Woolwich

International offices

China | Hong Kong SAR | India | Indonesia | Qatar | Malaysia | Middle East |
Singapore | South Africa | Thailand | Turkey

