



Benham & Reeves

Accolade Avenue, Southall, UB1

£347 per week, £1,504 per month + fees

 1 Bedroom  1 Bathroom  Furnished

Conveniently located 2nd floor suite style apartment situated within an outstanding Berkeley development on the Western fringe of London, featuring great views of the surrounding landscaped gardens.

Please [click here](#) for full detail

Property features

Suite Style Apartment | Concierge | Gym | Cinema room | Residents lounge | EPC-B | Balcony | Full Height Windows | Southall Amenities | Southall Station

For more information about this property,
please call our Southall branch on

020 8154 1089

Redress & Client Money Protection :

Benham and Reeves are members of The Property Ombudsman redress scheme and have Client Money protection with ARLA Propertymark. You can find more information on our website at <https://www.benhamandreeves.com/membership/>



Benham & Reeves

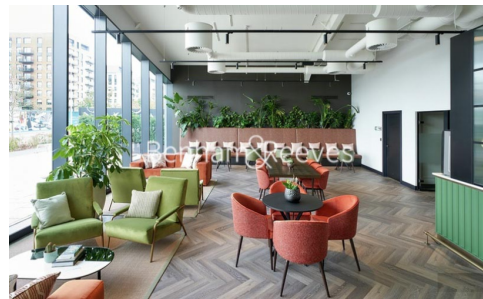
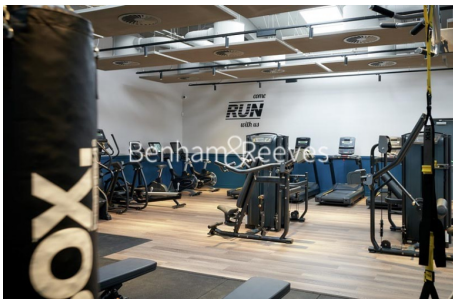

Accolade Avenue, Southall, UB1

£347 per week, £1,504 per month + fees

www.benhams.com

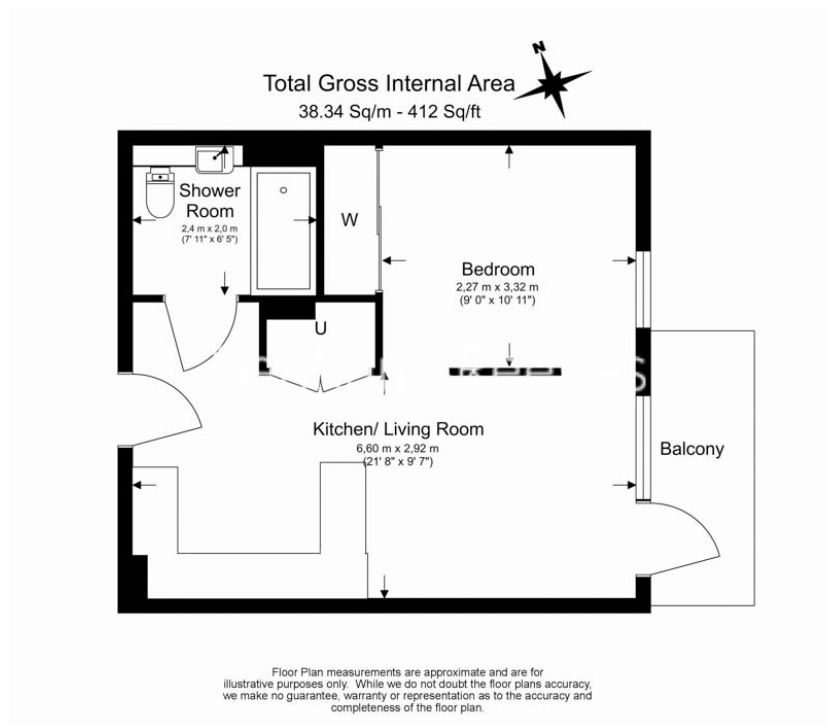

Score	Energy rating	Current	Potential
92+	A		
81-91	B	83 B	83 B
69-80	C		
55-68	D		
39-54	E		
21-38	F		
1-20	G		

London branches open six days a week Mon - Sat

Canary Wharf | City | Colindale | Dartmouth Park | Ealing | Fulham
Hammersmith | Hampstead | Highgate | Hyde Park | Kensington | Kew
Knightsbridge | Nine Elms | Shoreditch | Southall | Surrey Quays
Wapping | Wembley | White City | Woolwich

International offices

China | Hong Kong SAR | India | Indonesia | Qatar | Malaysia | Middle East |
Singapore | South Africa | Thailand | Turkey



Benham & Reeves