



Benham&Reeves

Gasholder Place, Nine Elms, SE11

£535 per week, £2,318 per month + fees

🛏 Studio 🚿 1 Bathroom 🛋 Furnished

A brand-new 7th floor Manhattan studio apartment situated in the latest phase of a desirable development located a 7-minute walk from Vauxhall and Oval Stations (Victoria and Northern Lines).

Please [click here](#) for full detail

Property features

Brand new | Manhattan Studio | Air cooling | Balcony | Separate sleeping area | EPC-B | 24-hour concierge | Residence Gym opening in November | Tesco located on site | Vauxhall station

For more information about this property,
please call our Nine Elms branch on

020 3282 3700

Redress & Client Money Protection :

Benham and Reeves are members of The Property Ombudsman redress scheme and have Client Money protection with ARLA Propertymark. You can find more information on our website at <https://www.benhams.com/membership/>



Benham & Reeves



Gasholder Place, Nine Elms, SE11

£535 per week, £2,318 per month + fees

www.benhams.com

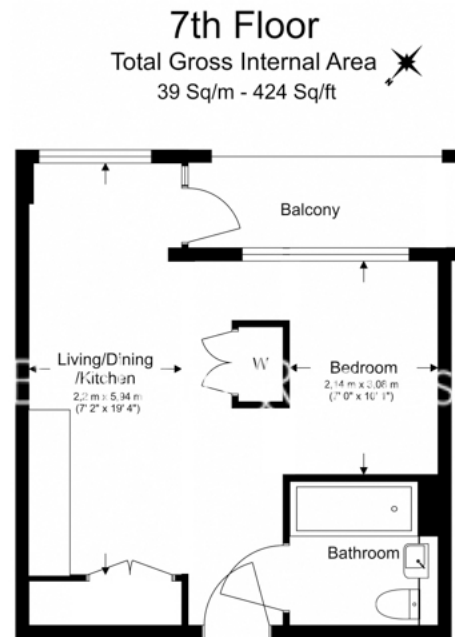

Floor Plan measurements are approximate and are for illustrative purposes only. While we do not doubt the floor plans accuracy, we make no guarantee, warranty or representation as to the accuracy and completeness of the floor plan.

Energy Efficiency Rating		
	Current	Potential
Very energy efficient - lower running costs		
(92-100) A		
(81-91) B	84	84
(69-80) C		
(55-68) D		
(39-54) E		
(21-38) F		
(1-20) G		
Not energy efficient - higher running costs		
England & Wales	EU Directive 2002/91/EC	

London branches open six days a week Mon - Sat

Canary Wharf | City | Colindale | Dartmouth Park | Ealing | Fulham
Hammersmith | Hampstead | Highgate | Hyde Park | Kensington | Kew
Knightsbridge | Nine Elms | Shoreditch | Southall | Surrey Quays
Wapping | Wembley | White City | Woolwich

International offices

China | Hong Kong SAR | India | Israel | Malaysia | Middle East | Pakistan
Qatar | Singapore | South Africa | Thailand | Turkey



Benham & Reeves