



Benham & Reeves

## High Street, Stratford, E15

£646 per week, £2,800 per month + fees

 3 Bedrooms    2 Bathrooms    Furnished

High specification spacious and furnished 9th floor apartment situated in a prestigious development with a host of amenities and excellent security close to Canary Wharf and the City. The closest DLR station is Pudding Mill Lane (5 min). The closest tube stations are Bromley-by-Bow (10 min) and Stratford (20 min). EPC-B

Please [click here](#) for full detail

## Property features

**Two Double bedroom, One single bedroom | Two Bathroom | Open Planned Living Room approx | Furnished | Fitted Kitchen | EPC-B | Concierge | High floor, city view | Direct transport links | Moments from Pudding Mill Lane DLR & Bromley-By-Bow Station**

For more information about this property,  
please call our Canary Wharf branch on

**020 8036 3200**

Redress & Client Money Protection :

Benham and Reeves are members of The Property Ombudsman redress scheme and have Client Money protection with ARLA Propertymark. You can find more information on our website at <https://www.benhamandreeves.com/membership/>



**Benham & Reeves**





# High Street, Stratford, E15

£646 per week, £2,800 per month + fees

www.benhams.com

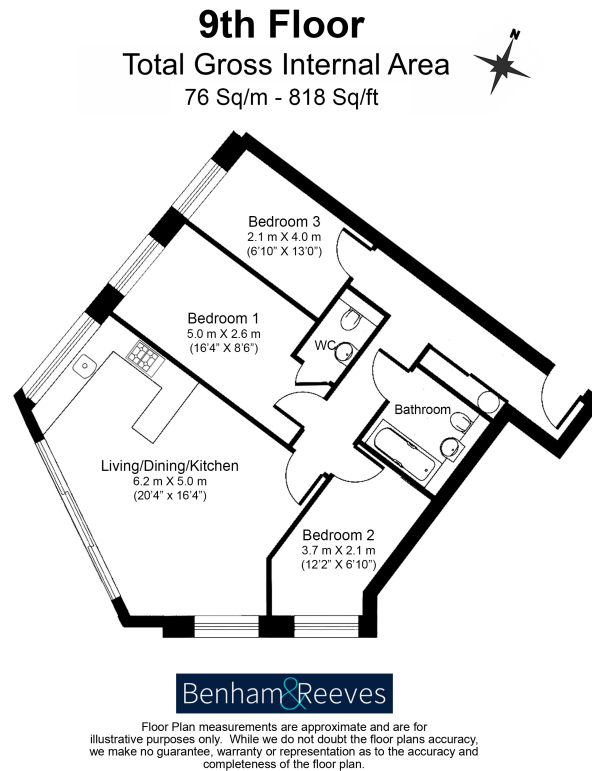

Energy Efficiency Rating		
	Current	Potential
Very energy efficient - lower running costs		
(92-100) A	88	88
(81-91) B		
(69-80) C		
(55-68) D		
(39-54) E		
(21-38) F		
(1-20) G		
Not energy efficient - higher running costs		
England & Wales	EU Directive 2002/91/EC	

## London branches open six days a week Mon - Sat

Canary Wharf | City | Colindale | Dartmouth Park | Ealing | Fulham  
Hammersmith | Hampstead | Highgate | Hyde Park | Kensington | Kew  
Knightsbridge | Nine Elms | Shoreditch | Southall | Surrey Quays  
Wapping | Wembley | White City | Woolwich

## International offices

China | Hong Kong SAR | India | Indonesia | Qatar | Malaysia | Middle East |  
Singapore | South Africa | Thailand | Turkey



Benham & Reeves