



Benham & Reeves

Cornmill Lane, Surrey Quays, SE13

£311 per week, £1,348 per month + fees

 1 Bedroom  1 Bathroom  Furnished

Modern Studio apartment set at the Renaissance development in Lewisham. The property is ideally located close to transport links and local amenities. EPC-B

Please [click here](#) for full detail

Property features

Separate Sleeping Area | 1 Bathroom | Open Plan Reception | Furnished | Fitted Kitchen | EPC-B | Dishwasher & Washing Machine | Private Balcony | Concierge Services | Nearby Lewisham Station

For more information about this property, please call our Property Management branch on

020 7319 9740

Redress & Client Money Protection :

Benham and Reeves are members of The Property Ombudsman redress scheme and have Client Money protection with ARLA Propertymark.

You can find more information on our website at <https://www.benhams.com/membership/>



Benham&Reeves



Cornmill Lane, Surrey Quays, SE13

£311 per week, £1,348 per month + fees

www.benhams.com

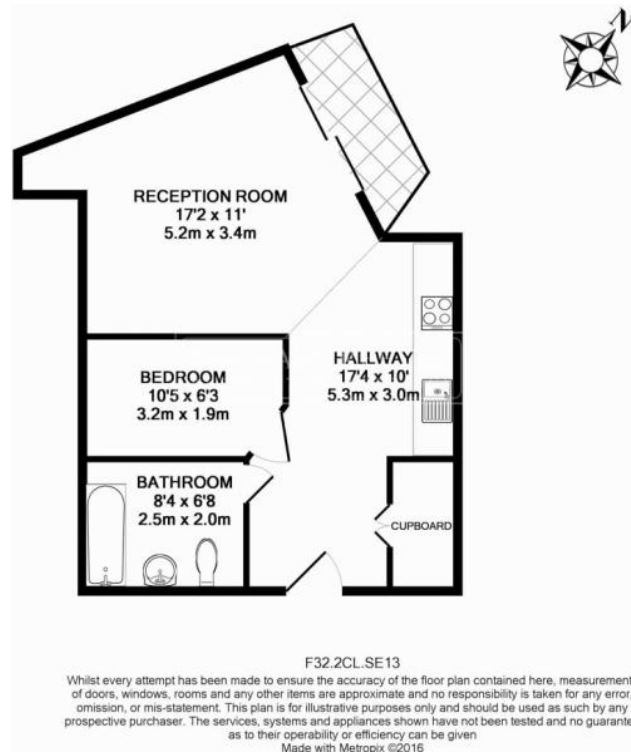

Energy Efficiency Rating

Very energy efficient - lower running costs

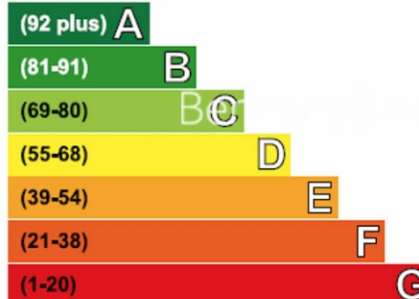

Not energy efficient - higher running costs

Current	Potential
84	84

London branches open six days a week Mon - Sat

Canary Wharf | City | Colindale | Dartmouth Park | Ealing | Fulham
Hammersmith | Hampstead | Highgate | Hyde Park | Kensington | Kew
Knightsbridge | Nine Elms | Shoreditch | Southall | Surrey Quays
Wapping | Wembley | White City | Woolwich

International offices

China | Hong Kong SAR | India | Indonesia | Qatar | Malaysia | Middle East |
Singapore | South Africa | Thailand | Turkey



Benham & Reeves