



Benham & Reeves

Ashton Reach, Surrey Quays, SE16

£544 per week, £2,357 per month + fees

 2 Bedrooms  1 Bathroom  Furnished

Bright, well-presented apartment situated within a vibrant, sought-after development with onsite residents' gym, a brief walk from Surrey Quays Station.

Please [click here](#) for full detail

Property features

Bright And Spacious | Open Plan Reception | Fully Integrated Kitchen | Private Balcony | 24 Hour Gym Access | EPC-B | 24 Hr Concierge | Greenland Surrey Quays Pier | Local Amenities On Site | Quick Walk To Surrey Quays Station

For more information about this property,
please call our Surrey Quays branch on

020 7740 3050

Redress & Client Money Protection :

Benham and Reeves are members of The Property Ombudsman redress scheme and have Client Money protection with ARLA Propertymark. You can find more information on our website at <https://www.benhamandreeves.com/membership/>



Benham&Reeves



Ashton Reach, Surrey Quays, SE16

£544 per week, £2,357 per month + fees

www.benhams.com

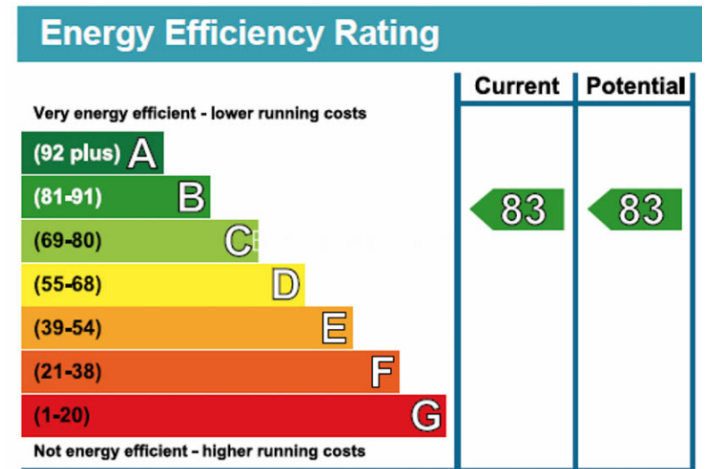
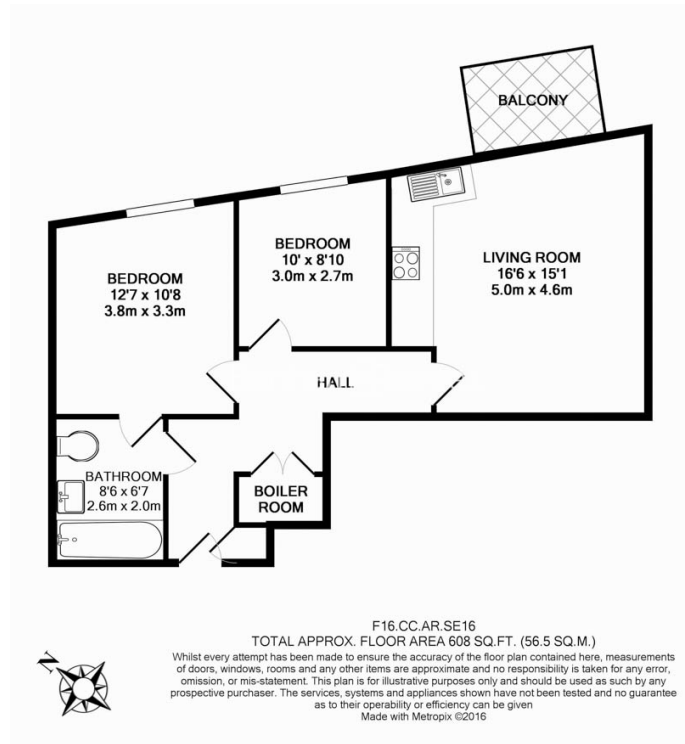

London branches open six days a week Mon - Sat

Canary Wharf | City | Colindale | Dartmouth Park | Ealing | Fulham
Hammersmith | Hampstead | Highgate | Hyde Park | Kensington | Kew
Knightsbridge | Nine Elms | Shoreditch | Southall | Surrey Quays
Wapping | Wembley | White City | Woolwich

International offices

China | Hong Kong SAR | India | Israel | Malaysia | Middle East | Pakistan
Qatar | Singapore | South Africa | Thailand | Turkey



Benham & Reeves