



Benham & Reeves

**Yeoman Street, Surrey Quays, SE16**

£485 per week, £2,100 per month + fees

 1 Bedroom    1 Bathroom    Furnished

Open Plan Reception | Modern Kitchen | Reception | Furnished | Residents Gym | EPC-B | 24 hour Concierge | Surrey Quays Station for Access into Shoreditch and City | On-site Co-op, Tesco, Local amenities | Private Balcony | Floor to Ceiling Windows

Please [click here](#) for full detail

## Property features

**Open Plan Reception | Modern Kitchen | Furnished | Residents Gym | On-site Co-op, Tesco, Local amenities | EPC-C | 24-hour Concierge | Private Balcony | Floor to Ceiling Windows | Surrey Quays Station for Access into Shoreditch and City**

For more information about this property,  
please call our Surrey Quays branch on

**020 7740 3050**

Redress & Client Money Protection :

Benham and Reeves are members of The Property Ombudsman redress scheme and have Client Money protection with ARLA Propertymark. You can find more information on our website at <https://www.benhamandreeves.com/membership/>



Benham&Reeves





# Yeoman Street, Surrey Quays, SE16

£485 per week, £2,100 per month + fees

www.benhams.com

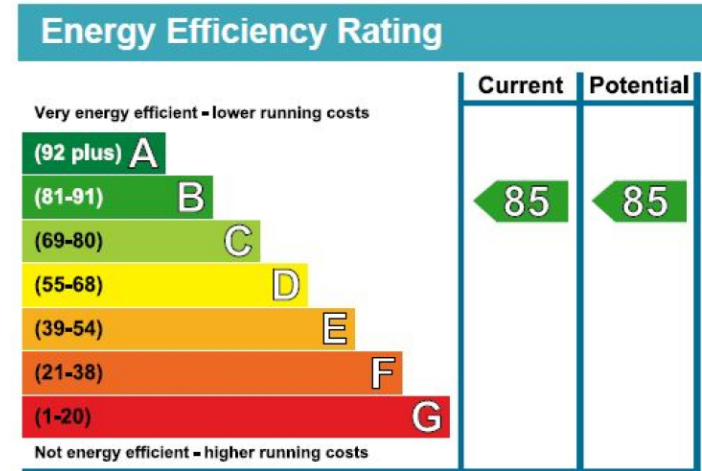
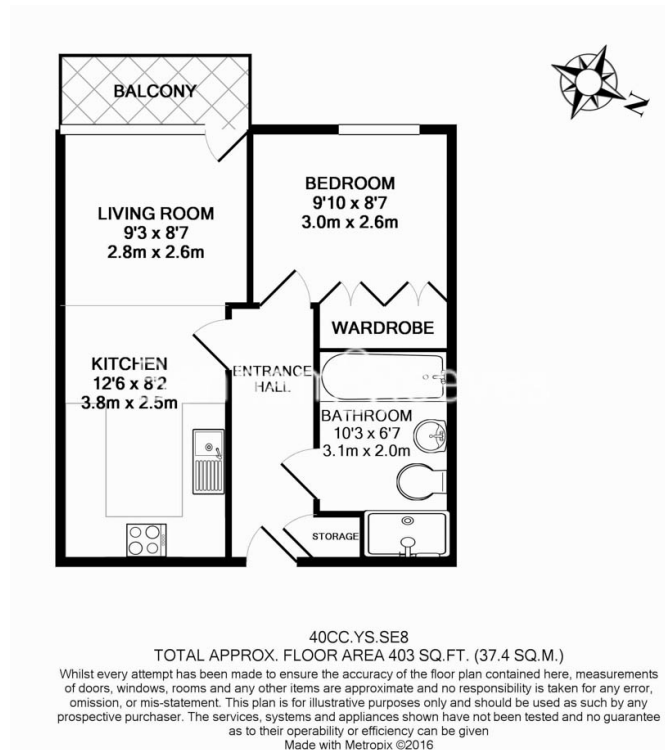

## London branches open six days a week Mon - Sat

Canary Wharf | City | Colindale | Dartmouth Park | Ealing | Fulham  
Hammersmith | Hampstead | Highgate | Hyde Park | Kensington | Kew  
Knightsbridge | Nine Elms | Shoreditch | Southall | Surrey Quays  
Wapping | Wembley | White City | Woolwich

## International offices

China | Hong Kong SAR | India | Indonesia | Qatar | Malaysia | Middle East | Pakistan  
Singapore | South Africa | Thailand | Turkey



Benham & Reeves