



Benham & Reeves

Chelsea Gate Apartments, SW1W

£850 per week, £3,683 per month + fees

 2 Bedrooms  2 Bathrooms  Furnished

A 950 sq ft TWO-BEDROOM flat with private BALCONY on the 2nd Floor of the CHELSEA GATE APARTMENTS on Ebury Bridge Road. Residents benefit from 24 HR CONCIERGE, FITNESS SUITE & Underground PARKING.

Please [click here](#) for full detail

Property features

2 Bedrooms | 2 Bathrooms | Parking Space | 950 sq ft | 24 Hr Concierge | EPC-C | Fitness Suite | Shops & Cafes nearby | Residents Courtyard | Sloane Square & Victoria Stations

For more information about this property,
please call our Knightsbridge branch on

020 7581 2112

Redress & Client Money Protection :

Benham and Reeves are members of The Property Ombudsman redress scheme and have Client Money protection with ARLA Propertymark. You can find more information on our website at <https://www.benhams.com/membership/>



Benham & Reeves



Chelsea Gate Apartments, SW1W

£850 per week, £3,683 per month + fees

www.benhams.com

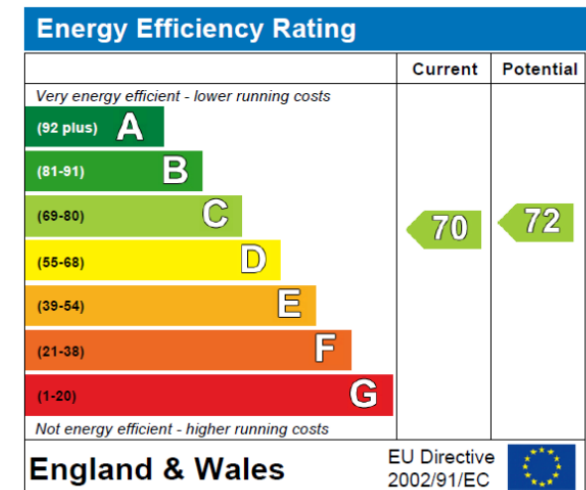
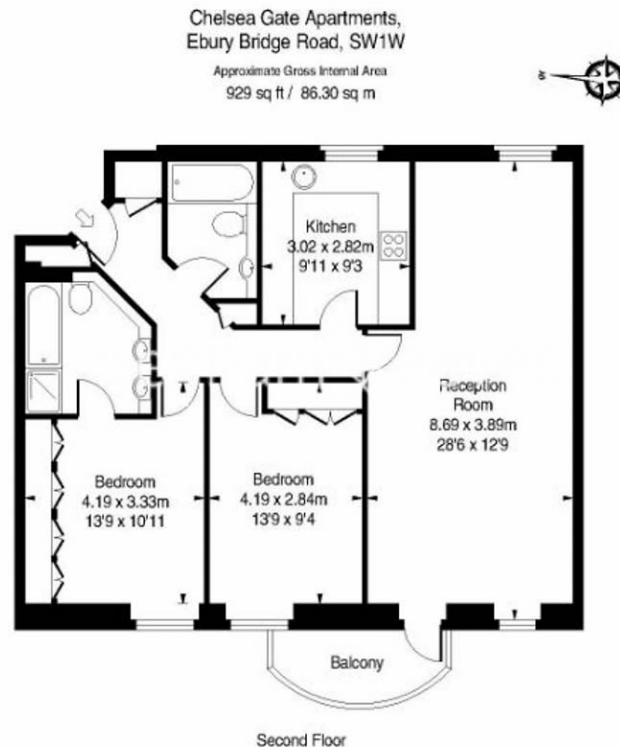

London branches open six days a week Mon - Sat

Canary Wharf | City | Colindale | Dartmouth Park | Ealing | Fulham
Hammersmith | Hampstead | Highgate | Hyde Park | Kensington | Kew
Knightsbridge | Nine Elms | Shoreditch | Southall | Surrey Quays
Wapping | Wembley | White City | Woolwich

International offices

China | Hong Kong SAR | India | Indonesia | Qatar | Malaysia | Middle East |
Singapore | South Africa | Thailand | Turkey



Benham & Reeves