



Benham & Reeves

Temple House, Temple Avenue, EC4Y

£700 per week, £3,033 per month + fees

 2 Bedrooms  2 Bathrooms  Furnished

Charming apartment situated in a Grade II listed period building within and exclusive address providing unrivalled access to the Thames and The City, sitting adjacent to the Vibrant South Bank.

Please [click here](#) for full detail

Property features

Two Bedrooms | Two Bathrooms | Open Plan Living Space | Separate Fitted Kitchen | Furnished | EPC-C | Excellent Transport Links | Onsite Building Porter | Blackfriars Station

For more information about this property,
please call our City branch on

020 7213 9700

Redress & Client Money Protection :

Benham and Reeves are members of The Property Ombudsman redress scheme and have Client Money protection with ARLA Propertymark. You can find more information on our website at <https://www.benhamandreeves.com/membership/>



Benham&Reeves



Temple House, Temple Avenue, EC4Y

£700 per week, £3,033 per month + fees

www.benhams.com

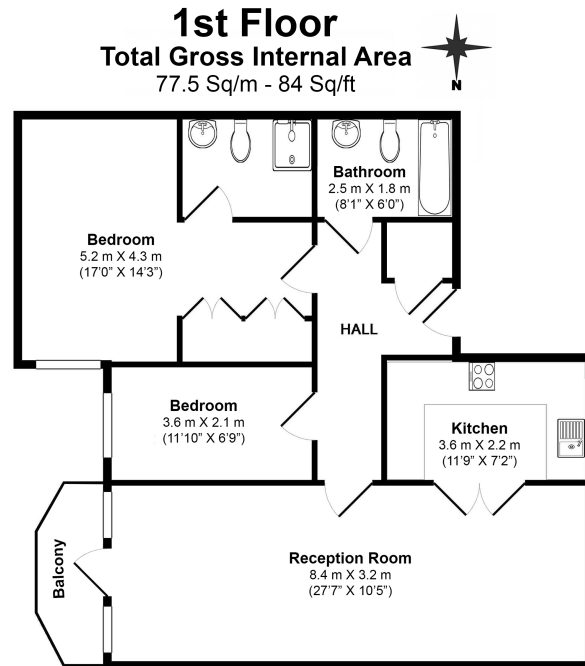

Floor Plan measurements are approximate and are for illustrative purposes only. While we do not doubt the floor plans accuracy, we make no guarantee, warranty or representation as to the accuracy and completeness of the floor plan.

Energy Efficiency Rating

Very energy efficient • lower running costs

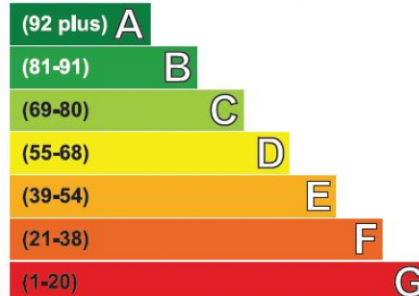

Current	Potential
76	83

Not energy efficient • higher running costs

London branches open six days a week Mon - Sat

Canary Wharf | City | Colindale | Dartmouth Park | Ealing | Fulham
Hammersmith | Hampstead | Highgate | Hyde Park | Kensington | Kew
Knightsbridge | Nine Elms | Shoreditch | Southall | Surrey Quays
Wapping | Wembley | White City | Woolwich

International offices

China | Hong Kong SAR | India | Indonesia | Qatar | Malaysia | Middle East |
Singapore | South Africa | Thailand | Turkey



Benham & Reeves