



Benham & Reeves

Sussex Way, Upper Holloway, N19

£375 per week, £1,625 per month + fees

🛏️ 1 Bedroom 🚿 1 Bathroom 🛋️ Furnished

Recently double glazed, wooden floors to a lounge and hall. Good size bedroom and spacious bathroom with designer sink. Great storage throughout, close to transport.

Please [click here](#) for full detail

Property features

One double bedroom | One bathroom | Gated development | Semi open plan kitchen reception room | Wood Flooring | EPC-D | Double glazing | Walking distance to tube and amenities | Nearby Upper Holloway and Archway Station

For more information about this property,
please call our Highgate branch on

020 8341 2335

Redress & Client Money Protection :

Benham and Reeves are members of The Property Ombudsman redress scheme and have Client Money protection with ARLA Propertymark. You can find more information on our website at <https://www.benhamandreeves.com/membership/>



Benham & Reeves



Sussex Way, Upper Holloway, N19

£375 per week, £1,625 per month + fees

www.benhams.com

2nd Floor
Total Gross Internal Area
45.8 Sq/m - 492 Sq/ft

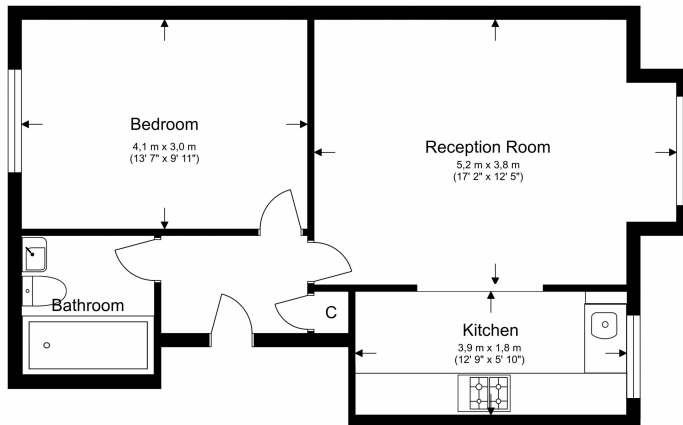

Benham & Reeves

Floor Plan measurements are approximate and are for illustrative purposes only. While we do not doubt the floor plans accuracy, we make no guarantee, warranty or representation as to the accuracy and completeness of the floor plan.

Score	Energy rating	Current	Potential
92+	A		
81-91	B		
69-80	C		79 C
55-68	D	68 D	
39-54	E		
21-38	F		
1-20	G		

London branches open six days a week Mon - Sat

Canary Wharf | City | Colindale | Dartmouth Park | Ealing | Fulham
Hammersmith | Hampstead | Highgate | Hyde Park | Kensington | Kew
Knightsbridge | Nine Elms | Shoreditch | Southall | Surrey Quays
Wapping | Wembley | White City | Woolwich

International offices

China | Hong Kong SAR | India | Indonesia | Qatar | Malaysia | Middle East | Pakistan
Singapore | South Africa | Thailand | Turkey



Benham & Reeves