



Benham & Reeves

**The Tower, Vauxhall, SW8**

£669 per week, £2,900 per month + fees

 Studio    1 Bathroom    Furnished

A modern Manhattan studio finished to a high standard and located in the sought after The Tower development at St Georges Wharf.

Please [click here](#) for full detail

## Property features

**Manhattan Studio | Separated sleeping area | Fully integrated appliances | Air cooling | Riverside development | EPC-B | 24 hour concierge | Swimming Pool | Gym | Nearby Vauxhall and Nine Elms Tube Stations**

For more information about this property, please call our Nine Elms branch on

**020 3282 3700**

Redress & Client Money Protection :  
Benham and Reeves are members of The Property Ombudsman redress scheme and have Client Money protection with ARLA Propertymark.  
You can find more information on our website at <https://www.benhams.com/membership/>



Benham & Reeves

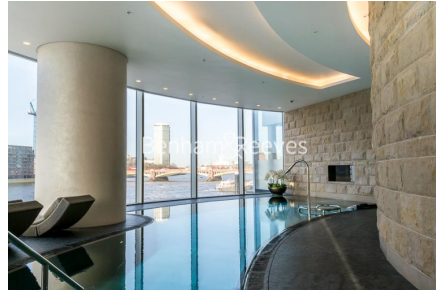

# The Tower, Vauxhall, SW8

£669 per week, £2,900 per month + fees

www.benhams.com

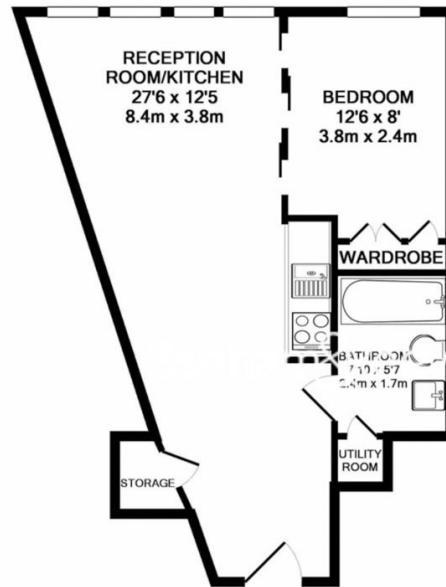

TOTAL APPROX. FLOOR AREA 424 SQ.FT. (39.4 SQ.M.)

Whilst every attempt has been made to ensure the accuracy of the floor plan contained here, measurements of doors, windows, rooms and any other items are approximate and no responsibility is taken for any error, omission, or mis-statement. This plan is for illustrative purposes only and should be used as such by any prospective purchaser. The services, systems and appliances shown have not been tested and no guarantee as to their operability or efficiency can be given.  
Made with Metropix ©2018

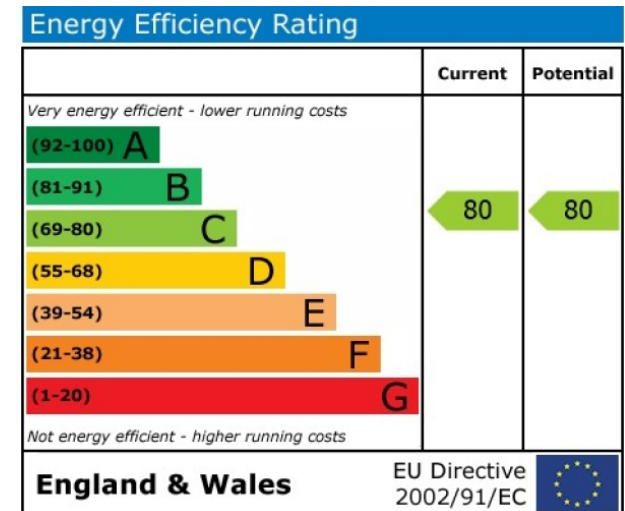

## London branches open six days a week Mon - Sat

Canary Wharf | City | Colindale | Dartmouth Park | Ealing | Fulham  
Hammersmith | Hampstead | Highgate | Hyde Park | Kensington | Kew  
Knightsbridge | Nine Elms | Shoreditch | Southall | Surrey Quays  
Wapping | Wembley | White City | Woolwich

## International offices

China | Hong Kong SAR | India | Indonesia | Qatar | Malaysia | Middle East |  
Singapore | South Africa | Thailand | Turkey



Benham & Reeves