



Benham & Reeves

Royal Westminster Lodge, Victoria, SW1P

£695 per week, £3,012 per month + fees

 2 Bedrooms  2 Bathrooms  Furnished

A wonderful 800 sq ft TWO-BEDROOM apartment with a daytime Porter & SECURE UNDERGROUND CAR PARKING, and situated in a quiet street in the heart of VICTORIA, close to Parliament Square. This well-appointed property has excellent storage, and is located just minutes from the vibrant amenities of Victoria Street. St. James's Park, Westminster & Victoria Underground Stations are minutes away.

Please [click here](#) for full detail

Property features

2 Bedrooms | 2 Bathrooms | Furnished or Un-Furnished | Separate Kitchen | Parking Space | EPC-C | 800 Sq Ft | Daytime Porter | Secure Underground Car Parking Space | Victoria, St James' Park & Westminster Stations

For more information about this property,
please call our Knightsbridge branch on

020 7581 2112

Redress & Client Money Protection :

Benham and Reeves are members of The Property Ombudsman redress scheme and have Client Money protection with ARLA Propertymark. You can find more information on our website at <https://www.benhamandreeves.com/membership/>



Benham & Reeves



Royal Westminster Lodge, Victoria, SW1P

£695 per week, £3,012 per month + fees

www.benhams.com

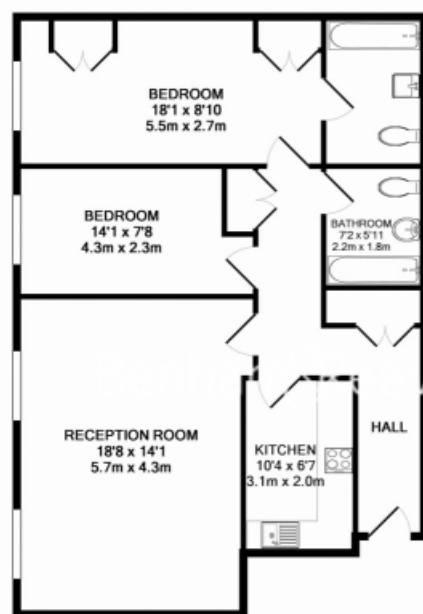

00167-22RWLSW1P - 2ND FLOOR
TOTAL APPROX. FLOOR AREA 800 SQ.FT. (74.3 SQ.M.)
Whilst every attempt has been made to ensure the accuracy of the floor plan contained here, measurements of doors, windows, rooms and any other items are approximate and no responsibility is taken for any error, omission, or mis-statement. This plan is for illustrative purposes only and should be used as such by any prospective purchaser. The services, systems and appliances shown have not been tested and no guarantee as to their operability or efficiency can be given.
Made with Metropix ©2015

Energy Efficiency Rating		
	Current	Potential
Very energy efficient - lower running costs		
(92 plus) A		
(81-91) B	81	85
(69-80) C		
(55-68) D		
(39-54) E		
(21-38) F		
(1-20) G		
Not energy efficient - higher running costs		
England & Wales		EU Directive 2002/91/EC

London branches open six days a week Mon - Sat

Canary Wharf | City | Colindale | Dartmouth Park | Ealing | Fulham
Hammersmith | Hampstead | Highgate | Hyde Park | Kensington | Kew
Knightsbridge | Nine Elms | Shoreditch | Southall | Surrey Quays
Wapping | Wembley | White City | Woolwich

International offices

China | Hong Kong SAR | India | Israel | Malaysia | Middle East | Pakistan
Qatar | Singapore | South Africa | Thailand | Turkey



Benham & Reeves