



Benham & Reeves

## **The Marlborough, Walton Street, SW3**

£695 per week, £3,012 per month + fees

 1 Bedroom     1 Bathroom     Furnished

A beautifully-presented 484 sq ft ONE-BEDROOM apartment in the popular MARLBOROUGH BUILDING on Chelsea's WALTON STREET. Overlooking the landscaped courtyard, enjoys a quiet position & bright outlook. Residents benefit from a daytime Porter & secure community.

Please [click here](#) for full detail

## Property features

**1 Bedroom | 1 Bathroom | Reception | Furnished | Eat-In Kitchen | EPC-C | 484 sq ft | Porter | Residents Courtyard | South Kensington & Sloane Square Stations**

For more information about this property,  
please call our Knightsbridge branch on

**020 7581 2112**

Redress & Client Money Protection :

Benham and Reeves are members of The Property Ombudsman redress scheme and have Client Money protection with ARLA Propertymark. You can find more information on our website at <https://www.benhamandreeves.com/membership/>



**Benham & Reeves**





# The Marlborough, Walton Street, SW3

£695 per week, £3,012 per month + fees

www.benhams.com

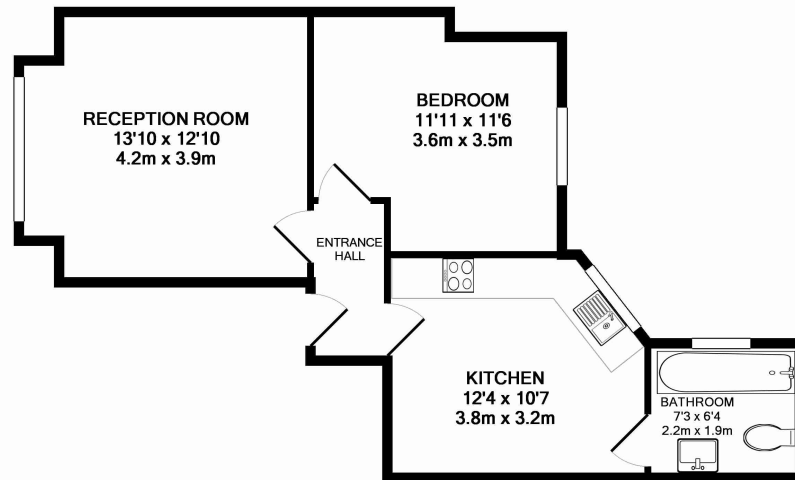

00273-42M.WS.SW3 - 2ND FLOOR  
TOTAL APPROX. FLOOR AREA 487 SQ.FT. (45.2 SQ.M.)

Whilst every attempt has been made to ensure the accuracy of the floor plan contained here, measurements of doors, windows, rooms and any other items are approximate and no responsibility is taken for any error, omission, or mis-statement. This plan is for illustrative purposes only and should be used as such by any prospective purchaser. The services, systems and appliances shown have not been tested and no guarantee as to their operability or efficiency can be given.  
Made with Metropix ©2015

## Energy Efficiency Rating

|   | Current | Potential |
|---|---------|-----------|
| Very energy efficient - lower running costs |         |           |
| (92 plus) A                                 |         |           |
| (81-91) B                                   |         |           |
| (69-80) C                                   | 72      | 76        |
| (55-68) D                                   |         |           |
| (39-54) E                                   |         |           |
| (21-38) F                                   |         |           |
| (1-20) G                                    |         |           |
| Not energy efficient - higher running costs |         |           |

## London branches open six days a week Mon - Sat

Canary Wharf | City | Colindale | Dartmouth Park | Ealing | Fulham  
Hammersmith | Hampstead | Highgate | Hyde Park | Kensington | Kew  
Knightsbridge | Nine Elms | Shoreditch | Southall | Surrey Quays  
Wapping | Wembley | White City | Woolwich

## International offices

China | Hong Kong SAR | India | Indonesia | Qatar | Malaysia | Middle East | Pakistan  
Singapore | South Africa | Thailand | Turkey



Benham & Reeves