



Benham & Reeves

Ram Quarter, Wandsworth, SW18

£842 per week, £3,649 per month + fees

 3 Bedrooms  2 Bathrooms  Furnished

A spacious 2nd floor apartment set in a new development in the heart of Wandsworth 0.9 miles from East Putney Station and across the road from Southside Shopping Centre.

Please [click here](#) for full detail

Property features

3 bedrooms | 2 bathrooms | Underfloor heating | Wood flooring | Integrated appliances | EPC-B | Underground Parking | Bicycle storage | Southside Shopping Center | Ram Quarter is 0.3 miles from Wandsworth Town Station

For more information about this property,
please call our Fulham branch on

020 7348 7620

Redress & Client Money Protection :

Benham and Reeves are members of The Property Ombudsman redress scheme and have Client Money protection with ARLA Propertymark. You can find more information on our website at <https://www.benhams.com/membership/>



Benham & Reeves

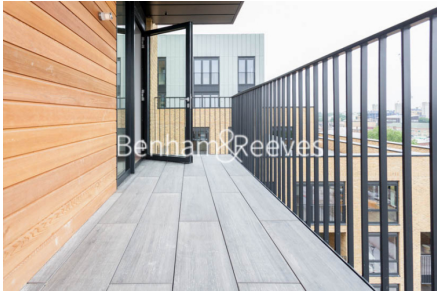

Ram Quarter, Wandsworth, SW18

£842 per week, £3,649 per month + fees

www.benhams.com

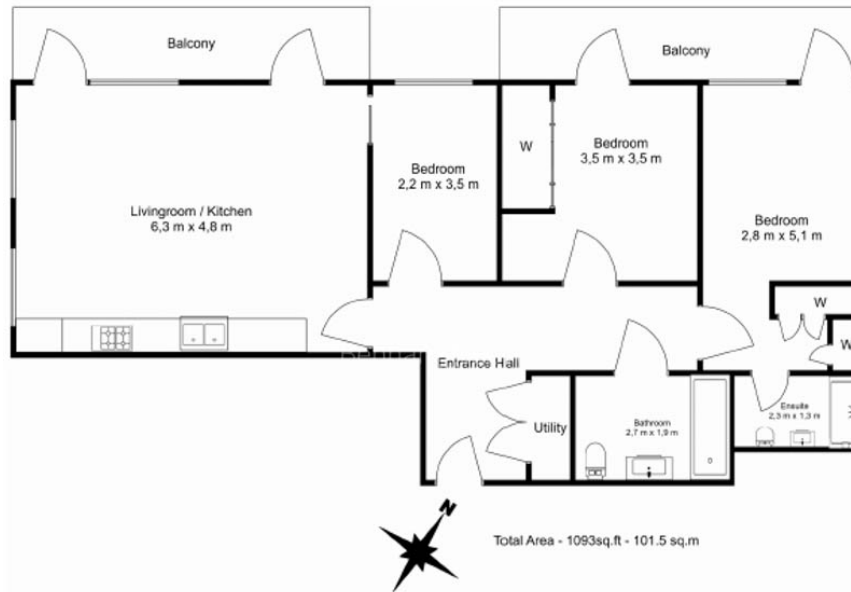

Energy Efficiency Rating

Very energy efficient - lower running costs

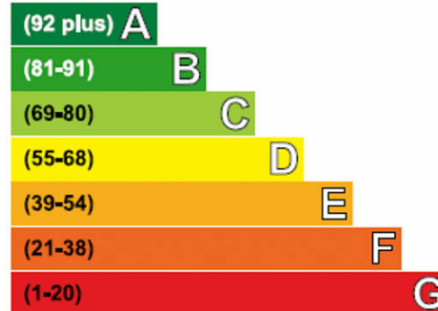

Not energy efficient - higher running costs

London branches open six days a week Mon - Sat

Canary Wharf | City | Colindale | Dartmouth Park | Ealing | Fulham
Hammersmith | Hampstead | Highgate | Hyde Park | Kensington | Kew
Knightsbridge | Nine Elms | Shoreditch | Southall | Surrey Quays
Wapping | Wembley | White City | Woolwich

International offices

China | Hong Kong SAR | India | Indonesia | Qatar | Malaysia | Middle East | Pakistan
Singapore | South Africa | Thailand | Turkey



Benham & Reeves