



Benham & Reeves

Royal Mint Street, Wapping, E1

£795 per week, £3,445 per month + fees

 2 Bedrooms  1 Bathroom  Furnished

Luxury apartment with exclusive resident facilities situated with a prestigious development in Aldgate. Located within a short walk into The City and minutes from the DLR and London Underground

Please [click here](#) for full detail

Property features

Luxury Furnished 2 Bedroom Apartment | Open Plan Reception / Living Area With Balcony | Interior Designed & Fully Equipped | Bespoke Fitted Kitchen With Integrated Siemens Appliances | Luxury Bathroom With Bespoke Vanity Counter | EPC-B | Timber Floors, LED Mood Lighting, Underfloor Heating | 24 Hour Concierge | Gym, Heated Pool & Jacuzzi, Residents Lounge with Reading Ar | Short Walk From The City & Minutes From Tower Hill Undergrou

For more information about this property,
please call our Wapping branch on

020 7680 8900

Redress & Client Money Protection :

Benham and Reeves are members of The Property Ombudsman redress scheme and have Client Money protection with ARLA Propertymark. You can find more information on our website at <https://www.benhamandreeves.com/membership/>



Benham&Reeves



Royal Mint Street, Wapping, E1

£795 per week, £3,445 per month + fees

www.benhams.com

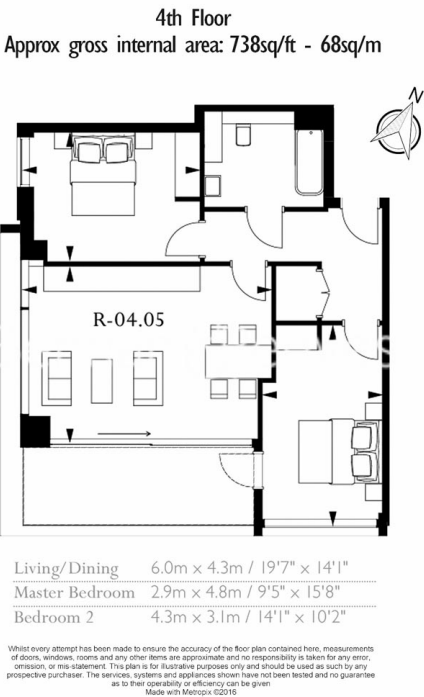

Score	Energy rating	Current	Potential
92+	A		
81-91	B	84 B	84 B
69-80	C		
55-68	D		
39-54	E		
21-38	F		
1-20	G		

London branches open six days a week Mon - Sat

Canary Wharf | City | Colindale | Dartmouth Park | Ealing | Fulham
Hammersmith | Hampstead | Highgate | Hyde Park | Kensington | Kew
Knightsbridge | Nine Elms | Shoreditch | Southall | Surrey Quays
Wapping | Wembley | White City | Woolwich

International offices

China | Hong Kong SAR | India | Indonesia | Qatar | Malaysia | Middle East |
Singapore | South Africa | Thailand | Turkey

