



Benham & Reeves

Radnor Terrace, West Kensington, W14

£700 per week, £3,033 per month + fees

 1 Bedroom  1 Bathroom 
Furnished/UnFurnished

A stunning 2nd floor luxury apartment situated in one of London's most opulent developments in the heart of Kensington. The property is located nearby Kensington Olympia (District Line) underground and Overground stations which have excellent services around London.

Please [click here](#) for full detail

Property features

**1 Bedroom | 1 Bathroom | Reception | Furn/Unfurn | Fitted Kitchen | EPC-B | Cinema | Gym & Spa
| Nearby Kensington Olympia (District Line)**

For more information about this property,
please call our Kensington branch on

020 7938 3522

Redress & Client Money Protection :

Benham and Reeves are members of The Property Ombudsman redress scheme and have Client Money protection with ARLA Propertymark. You can find more information on our website at <https://www.benhams.com/membership/>



Benham & Reeves



Radnor Terrace, West Kensington, W14

£700 per week, £3,033 per month + fees

www.benhams.com

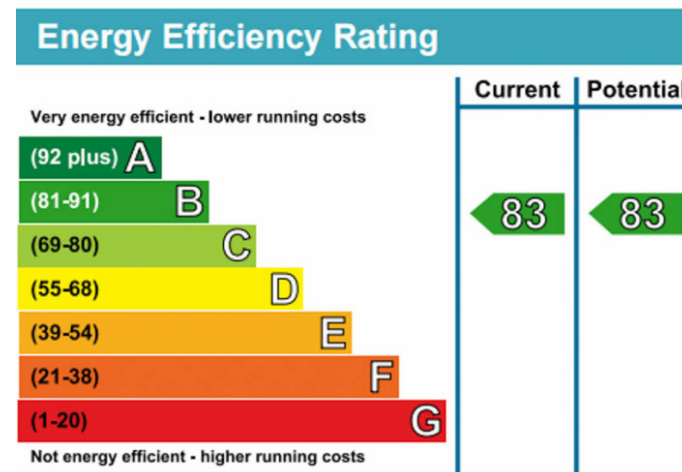
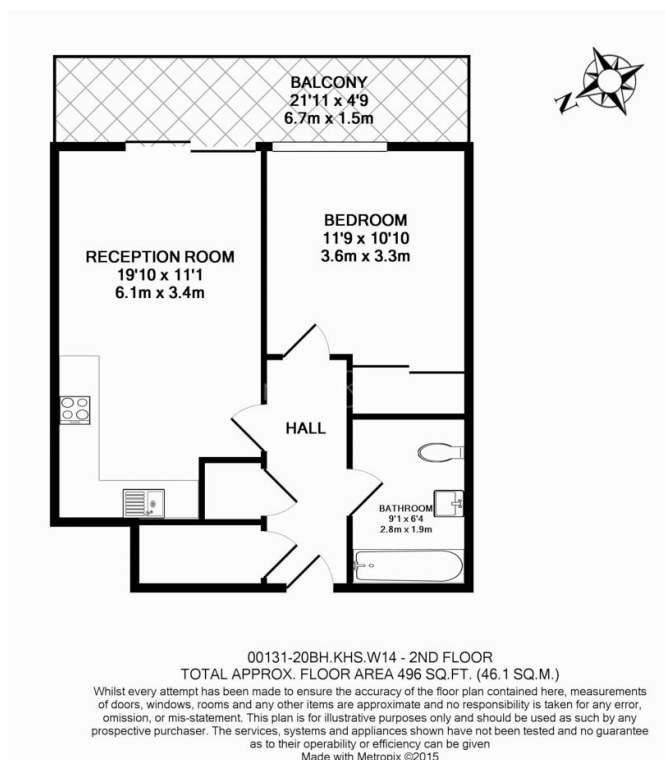

London branches open six days a week Mon - Sat

Canary Wharf | City | Colindale | Dartmouth Park | Ealing | Fulham
Hammersmith | Hampstead | Highgate | Hyde Park | Kensington | Kew
Knightsbridge | Nine Elms | Shoreditch | Southall | Surrey Quays
Wapping | Wembley | White City | Woolwich

International offices

China | Hong Kong SAR | India | Indonesia | Qatar | Malaysia | Middle East | Pakistan
Singapore | South Africa | Thailand | Turkey



Benham & Reeves