



Benham & Reeves

Radnor Terrace, West Kensington, W14

£670 per week, £2,903 per month + fees

🛏 1 Bedroom 🚿 1 Bathroom 🛋 Furnished

A tastefully presented luxury apartment set in a highly sought-after prestigious development in Kensington. The development is conveniently positioned within walking distance of Kensington Olympia (District Line) Underground and Overground station.

Please [click here](#) for full detail

Property features

1 Bedroom | 1 Bathroom | Reception | Furnished | Fitted Kitchen | EPC-B | Swimming Pool, Gym, Spa | Porter, Lift | Nearby Earls court and Olympia tube

For more information about this property,
please call our Kensington branch on

020 7938 3522

Redress & Client Money Protection :

Benham and Reeves are members of The Property Ombudsman redress scheme and have Client Money protection with ARLA Propertymark. You can find more information on our website at <https://www.benhamandreeves.com/membership/>



Benham & Reeves



Radnor Terrace, West Kensington, W14

£670 per week, £2,903 per month + fees

www.benhams.com

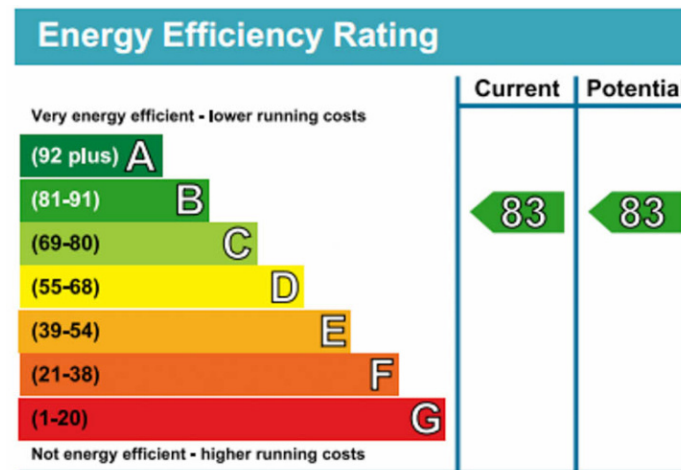
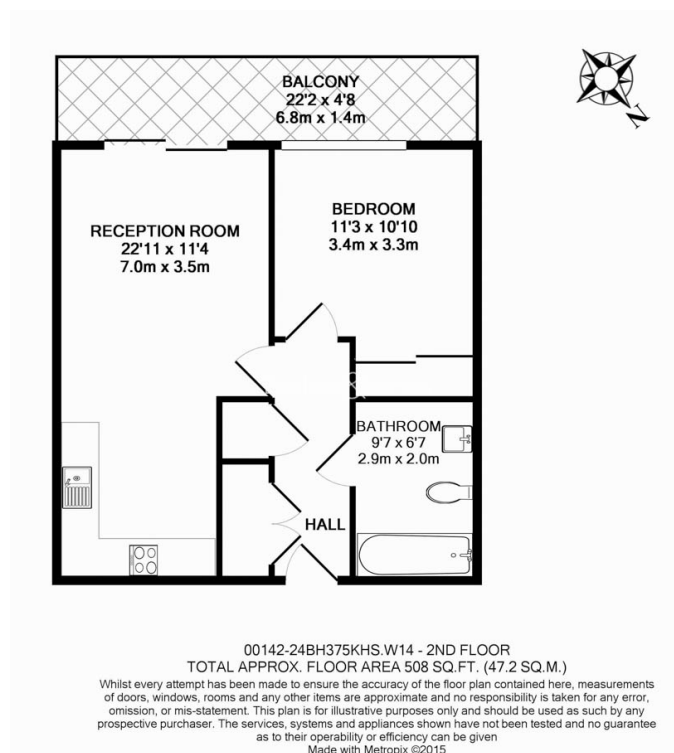

London branches open six days a week Mon - Sat

Canary Wharf | City | Colindale | Dartmouth Park | Ealing | Fulham
Hammersmith | Hampstead | Highgate | Hyde Park | Kensington | Kew
Knightsbridge | Nine Elms | Shoreditch | Southall | Surrey Quays
Wapping | Wembley | White City | Woolwich

International offices

China | Hong Kong SAR | India | Indonesia | Qatar | Malaysia | Middle East | Pakistan
Singapore | South Africa | Thailand | Turkey



Benham & Reeves