



Benham & Reeves

## **Royal Docks West, Western Gateway, E16**

£531 per week, £2,301 per month + fees

🛏️ 2 Bedrooms    🚿 2 Bathrooms    🛋️ Furnished

A modern bright 5th floor apartment, with cycle storage, set in a new development in E16. Custom House and Prince Regent are the closest DLR stations offering easy access to Canary Wharf & The City.

Please [click here](#) for full detail

## Property features

**Two Double Bedrooms | Two Bathrooms | Open Planned Living Space | Fitted Kitchen | Furnished | EPC-B | 24 Hour Concierge | Cycle Storage | Royal Victoria Dlr Station Nearby**

For more information about this property, please call our Property Management branch on

**020 7319 9740**

Redress & Client Money Protection :

Benham and Reeves are members of The Property Ombudsman redress scheme and have Client Money protection with ARLA Propertymark. You can find more information on our website at <https://www.benhams.com/membership/>



Benham & Reeves

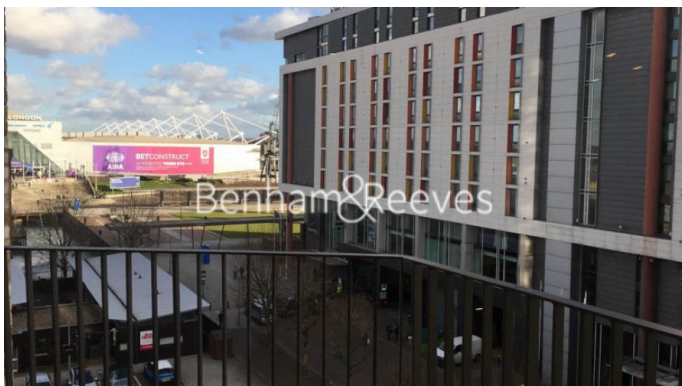



# Royal Docks West, Western Gateway, E16

£531 per week, £2,301 per month + fees

www.benhams.com

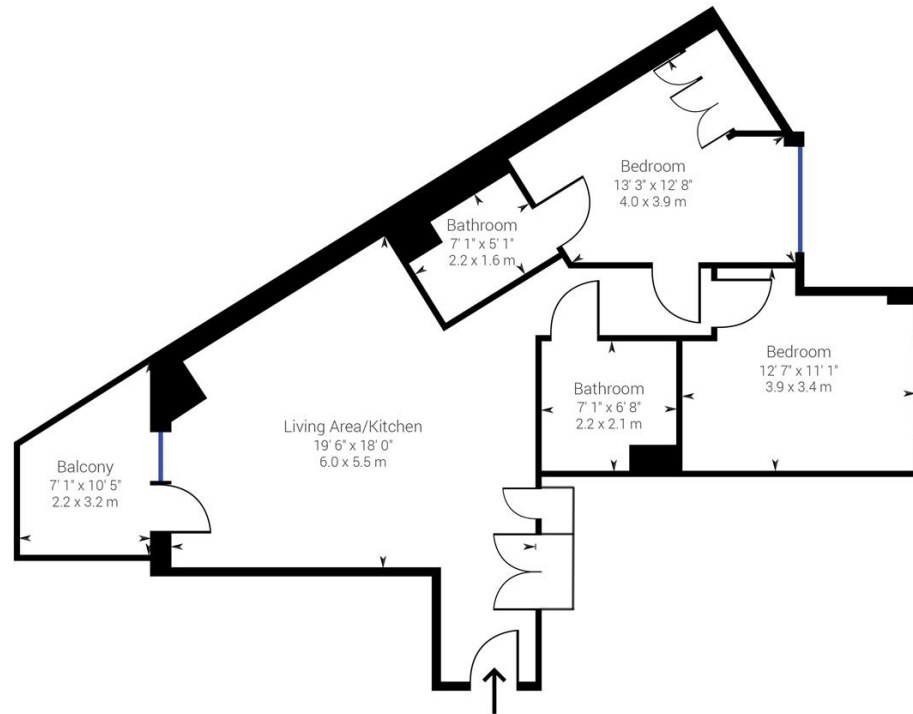

## Energy Efficiency Rating

Very energy efficient - lower running costs

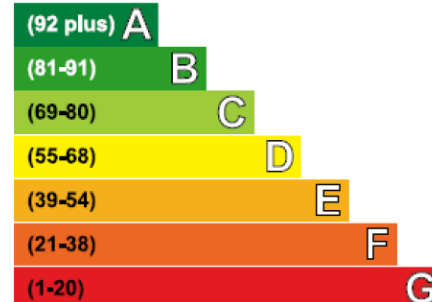

Not energy efficient - higher running costs

## London branches open six days a week Mon - Sat

Canary Wharf | City | Colindale | Dartmouth Park | Ealing | Fulham  
Hammersmith | Hampstead | Highgate | Hyde Park | Kensington | Kew  
Knightsbridge | Nine Elms | Shoreditch | Southall | Surrey Quays  
Wapping | Wembley | White City | Woolwich

## International offices

China | Hong Kong SAR | India | Indonesia | Qatar | Malaysia | Middle East |  
Singapore | South Africa | Thailand | Turkey



Benham & Reeves