



Benham & Reeves

Royal Victoria Gardens, Whiting Way, SE16

£565 per week, £2,448 per month + fees

 2 Bedrooms  2 Bathrooms  Furnished

A well-presented apartment situated within a sought-after riverside development with residents' gym. The property is ideally located close to Surrey Quays Overground and Canada Water underground stations.

Please [click here](#) for full detail

Property features

Two Double Bedrooms | Onsite Tesco, Co-op, Popular Australian Restaurant | Fitted Kitchen | Local Restaurants, Cafes and Bars Nearby | Lift Access | EPC-B | 24-hour concierge | Two Bathrooms | Furnished with Private Balcony | Surrey Quays Station for Access into Shoreditch and City

For more information about this property,
please call our Surrey Quays branch on

020 7740 3050



Redress & Client Money Protection :
Benham and Reeves are members of The Property Ombudsman redress scheme and have Client Money protection with ARLA Propertymark.
You can find more information on our website at <https://www.benhams.com/membership/>

Benham&Reeves

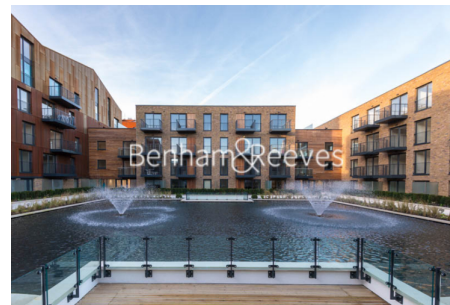

Royal Victoria Gardens, Whiting Way, SE16

£565 per week, £2,448 per month + fees

www.benhams.com

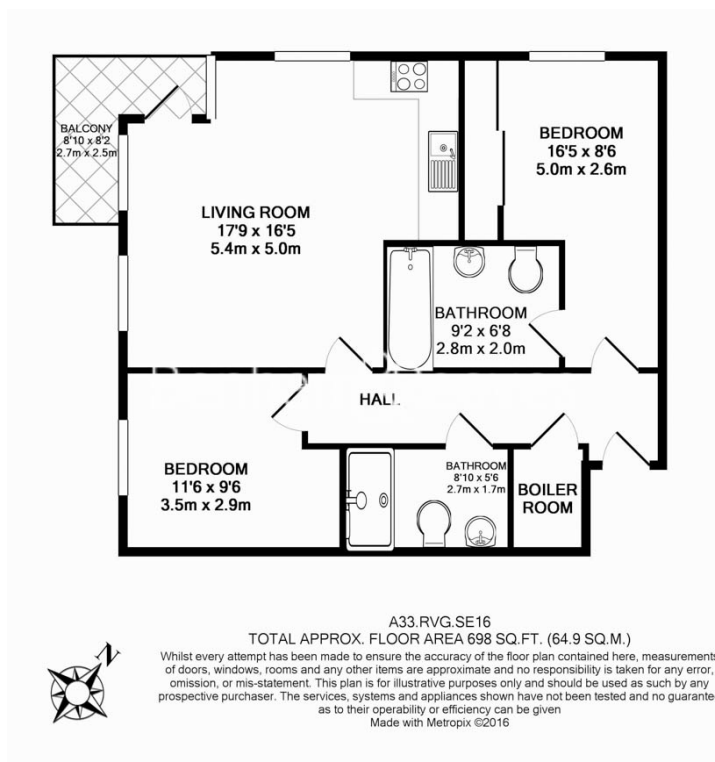

Energy Efficiency Rating

Very energy efficient - lower running costs

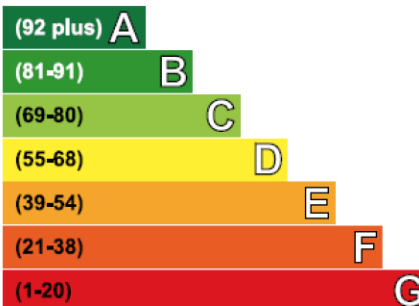

Not energy efficient - higher running costs

Current	Potential
86	86

London branches open six days a week Mon - Sat

Canary Wharf | City | Colindale | Dartmouth Park | Ealing | Fulham
Hammersmith | Hampstead | Highgate | Hyde Park | Kensington | Kew
Knightsbridge | Nine Elms | Shoreditch | Southall | Surrey Quays
Wapping | Wembley | White City | Woolwich

International offices

China | Hong Kong SAR | India | Indonesia | Qatar | Malaysia | Middle East | Pakistan
Singapore | South Africa | Thailand | Turkey



Benham & Reeves