



Benham & Reeves

Vista Building, Woolwich, SE18

£415 per week, £1,800 per month + fees

 2 Bedrooms  2 Bathrooms  Part-furnished

Spacious decorated, part furnished 5th floor apartment situated in a secure development in Central Woolwich. Close to both DRL and Elizabeth Line tube station.

Please [click here](#) for full detail

Property features

2 bed 2 bath property located on the 5th floor | Part furnished | Open plan kitchen with spacious living room | Family bathroom | Both double bedrooms and the master room attached | EPC- D | Concierge service | Close to local amenities | Moments to Woolwich DLR station and Tube Station

For more information about this property,
please call our Woolwich branch on

020 8051 0700

Redress & Client Money Protection :

Benham and Reeves are members of The Property Ombudsman redress scheme and have Client Money protection with ARLA Propertymark. You can find more information on our website at <https://www.benhams.com/membership/>



Benham & Reeves



Vista Building, Woolwich, SE18

£415 per week, £1,800 per month + fees

www.benhams.com

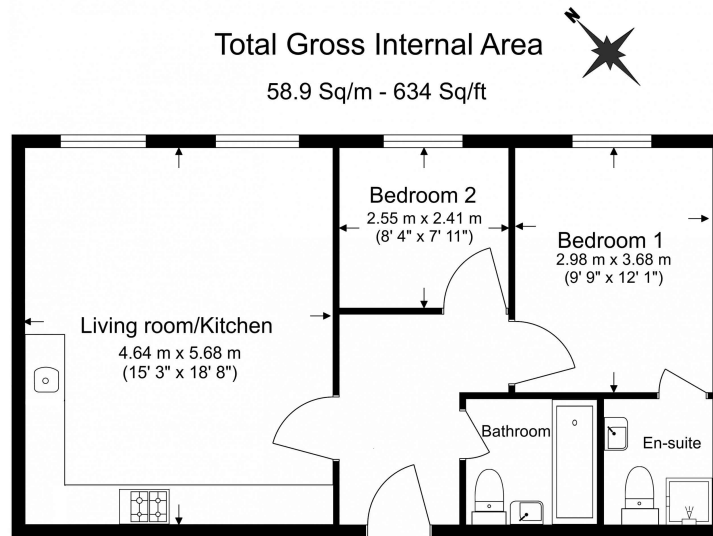

Benham & Reeves

Floor Plan measurements are approximate and are for illustrative purposes only. While we do not doubt the floor plans accuracy, we make no guarantee, warranty or representation as to the accuracy and completeness of the floor plan.

Score	Energy rating	Current	Potential
92+	A		
81-91	B		
69-80	C		
55-68	D	62 D	63 D
39-54	E		
21-38	F		
1-20	G		

London branches open six days a week Mon - Sat

Canary Wharf | City | Colindale | Dartmouth Park | Ealing | Fulham
Hammersmith | Hampstead | Highgate | Hyde Park | Kensington | Kew
Knightsbridge | Nine Elms | Shoreditch | Southall | Surrey Quays
Wapping | Wembley | White City | Woolwich

International offices

China | Hong Kong SAR | India | Indonesia | Qatar | Malaysia | Middle East |
Singapore | South Africa | Thailand | Turkey



Benham & Reeves