



Benham & Reeves

Erebus Drive, Woolwich, SE28

£438 per week, £1,900 per month + fees

 2 Bedrooms  2 Bathrooms  Furnished

Bright, stylish apartment with direct River views, and secure underground parking situated in a modern development in the popular West Thamesmead area. For excellent transport links, Woolwich Arsenal Station is a short walk away.

Please [click here](#) for full detail

Property features

2 Double Bedroom with Built-in Wardrobes | 2 Luxury Spacious Bathroom (1x En-Suite Shower & 1 xBathroom) | Separate integrated kitchen | Internal Area: 800 SqFt | Good Size Hallway / AmpleStorage \ Private Terrace | EPC-C | Direct river view terrace | Underground parking included | Moments to Woolwich DLR and Woolwich Cross-Rail station

For more information about this property,
please call our Woolwich branch on

020 8051 0700

Redress & Client Money Protection :

Benham and Reeves are members of The Property Ombudsman redress scheme and have Client Money protection with ARLA Propertymark. You can find more information on our website at <https://www.benhams.com/membership/>



Benham & Reeves

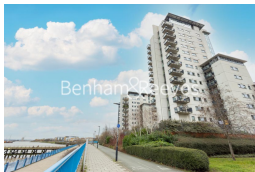
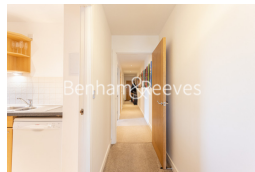

Erebus Drive, Woolwich, SE28

£438 per week, £1,900 per month + fees

www.benhams.com

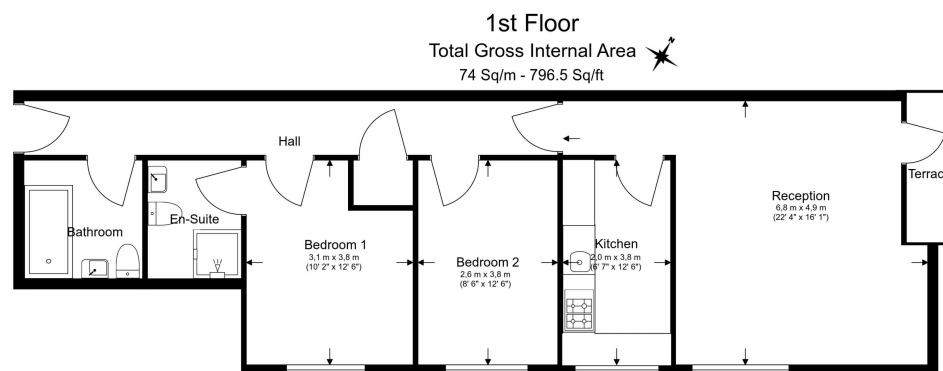

Floor Plan measurements are approximate and are for illustrative purposes only. While we do not doubt the floor plans accuracy, we make no guarantee, warranty or representation as to the accuracy and completeness of the floor plan.

Score	Energy rating	Current	Potential
92+	A		
81-91	B		
69-80	C	77 c	78 c
55-68	D		
39-54	E		
21-38	F		
1-20	G		

London branches open six days a week Mon - Sat

Canary Wharf | City | Colindale | Dartmouth Park | Ealing | Fulham
Hammersmith | Hampstead | Highgate | Hyde Park | Kensington | Kew
Knightsbridge | Nine Elms | Shoreditch | Southall | Surrey Quays
Wapping | Wembley | White City | Woolwich

International offices

China | Hong Kong SAR | India | Indonesia | Qatar | Malaysia | Middle East |
Singapore | South Africa | Thailand | Turkey



Benham & Reeves